

Type VUS/INC/B check valves

- Poppet type

└─ Port size
VUS/INC/B 14/Pa0,5
└─ Opening pressure (bar)

Type	Selection 1	Selection 2	Nominal flow	Max. pressure	ports	weight
			l/min(US gpm)	bar(psi)		Kg(lb)
VUS/INC/B14	PaXX	-	20 (5.3)	350 (5100)	All G1/4	0.01 (0.02)
VUS/INC/B38			50 (13.2)	350 (5100)	All G3/8	0.02 (0.04)
VUS/INC/B12			80 (21.1)	350 (5100)	All G1/2	0.03 (0.06)

Hydraulic diagram	Type	Execution	Operation/ Features	Max. flow up to		Max.press. up to	
				l/min	US gpm	bar	psi
	VUS/INC/A	poppet type		80	21.1	350	5100

Ordering codes and description

└─ Port size
VUS/INC/B 14/Pa0,5
└─ Opening pressure (bar)

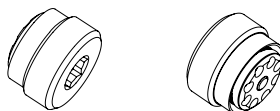

Dimensions

Dimensions are in mm-in

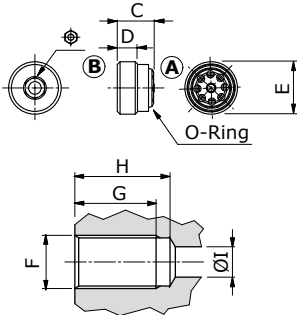

Valve type	ØC	D	E	⊕	O-Ring
VUS/INC/B14	10 - 0.39	6 - 0.24	G 1/4	5	1x9
VUS/INC/B38	11.5 - 0.45	7 - 0.27	G 3/8	6	1.5x10
VUS/INC/B12	13.5 - 0.53	8 - 0.31	G 1/2	8	1.6x14.1

Valve cavity for	F	G	H	ØI
VUS/INC/B14	G 1/4	21.5 - 0.85	24 - 0.94	7 - 0.27
VUS/INC/B38	G 3/8	23 - 0.90	25.5 - 1	9 - 0.35
VUS/INC/B12	G 1/2	28 - 1.10	30.5 - 1.2	12 - 0.47